

## Clamp x Clamp x Clamp Instrument Tees

Size (inch)	Dim (A)	Dim (B)	PL Finish - SF1		PM Finish - SF4	
			Part No.	Price \$	Part No.	Price \$
½ x 1½	152.40	22.225	T7IMPS-050150PL	495.77	T7IMPS-050150PM	622.80
¾ x 1½	152.40	25.400	T7IMPS-075150PL	501.72	T7IMPS-075150PM	643.45
1 x 1½	152.40	28.575	T7IMPS-100150PL	539.98	T7IMPS-100150PM	645.47
½ x 2	165.10	25.400	T7IMPS-050200PL	609.67	T7IMPS-050200PM	751.40
¾ x 2	165.10	28.575	T7IMPS-075200PL	539.98	T7IMPS-075200PM	667.01
1 x 2	165.10	31.750	T7IMPS-100200PL	707.19	T7IMPS-100200PM	848.92
1½ x 2	165.10	38.100	T7IMPS150200PL	605.37	T7IMPS150200PM	697.00

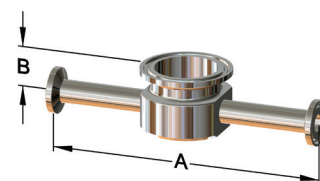

BPE Table #DT-29

Price Group: DS

## Weld x Weld Concentric Reducers

AV14

Size (inch)	Dim (A)	PL Finish - SF1		PM Finish - SF4	
		Part No.	Price \$	Part No.	Price \$
¾ x ½	101.60	T31W-075050PL	114.70	T31W-075050PM	137.75
1 x ½	114.30	T31W-100050PL	143.89	T31W-100050PM	152.44
1 x ¾	101.60	T31W-100075PL	87.49	T31W-100075PM	127.61
1½ x ½	139.70	T31W-150050PL	138.28	T31W-150050PM	183.89
1½ x ¾	127.00	T31W-150075PL	101.41	T31W-150075PM	176.43
1½ x 1	127.00	T31W-150100PL	125.86	T31W-150100PM	121.04
2 x ½	196.85	T31W-200050PL	225.22	T31W-200050PM	295.21
2 x ¾	184.15	T31W-200075PL	200.59	T31W-200075PM	226.95
2 x 1	184.15	T31W-200100PL	139.26	T31W-200100PM	206.24
2 x 1½	133.35	T31W-200150PL	128.41	T31W-200150PM	155.61
2½ x ½	247.65	T31W-250050PL	280.42	T31W-250050PM	371.47
2½ x ¾	234.95	T31W-250075PL	236.00	T31W-250075PM	328.38
2½ x 1	234.95	T31W-250100PL	198.49	T31W-250100PM	291.95
2½ x 1½	184.15	T31W-250150PL	221.96	T31W-250150PM	439.64
2½ x 2	139.70	T31W-250200PL	237.19	T31W-250200PM	367.57
3 x 1	285.75	T31W-300100PL	298.78	T31W-300100PM	389.53
3 x 1½	234.95	T31W-300150PL	230.71	T31W-300150PM	850.30
3 x 2	190.50	T31W-300200PL	165.55	T31W-300200PM	241.72
3 x 2½	139.70	T31W-300250PL	145.91	T31W-300250PM	248.09
4 x 1	393.70	T31W-400100PL	500.11	T31W-400100PM	608.62
4 x 1½	342.90	T31W-400150PL	444.28	T31W-400150PM	552.72
4 x 2	298.45	T31W-400200PL	379.38	T31W-400200PM	480.81
4 x 2½	247.65	T31W-400250PL	305.45	T31W-400250PM	413.89
4 x 3	196.85	T31W-400300PL	275.72	T31W-400300PM	394.99
6 x 3	254.00	T31W-600300PL	1085.76	T31W-600300PM	1405.14
6 x 4	254.00	T31W-600400PL	1093.76	T31W-600400PM	1413.52

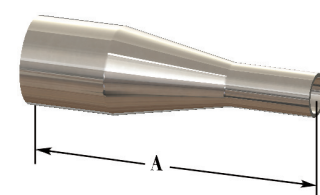

BPE Table #DT-11

Price Group: DS

AV14

Note: Not all sizes and finishes are stocked.

PL Finish - SF1

OD = 32R<sub>s</sub> Mechanically Polished

ID = 20R<sub>s</sub> Mechanically Polished

PM Finish - SF4

OD = 32R<sub>s</sub> Mechanically Polished

ID = 15R<sub>s</sub> Mechanically Polished & Electropolished