

Flow Chief Internal Expansion (IX) Hose Couplings

Features:

- Sanitary style x triclamp end
- 304 stainless steel
- Meets FDA and USDA sanitary standards
- Flow Chief internal expansion (IX) fittings are only to be used with Flow Chief stainless steel ferrules.
- Refer to pages 355-357 for sanitary style gaskets
- Refer to page 353 for sanitary style clamps

Hose Size (inch)	Part No.	Price \$
1½	IXSE24	124.10
2	IXSE32	222.67
2½	IXSE40	474.95
3	IXSE48	517.11
4	IXSE64	719.56

Price Group: DS

(IX) Male NPT Stems

AV01

Features:

- 304 stainless steel
- Meets FDA and USDA sanitary standards
- Flow Chief internal expansion (IX) fittings are only to be used with Flow Chief stainless steel ferrules.

Hose Size (inch)	Part No.	Price \$
1½	IXMS24	369.55
2	IXMS32	245.91
2½	IXMS40	115.90
3	IXMS48	515.84
4	IXMS64	805.56

Price Group: DS

AV01

Holedall™ / Sanitary Assemblies

Flow Chief stainless steel food grade fittings and internally swaged hose assemblies are designed for various pharmaceutical and food handling applications, including processing of beer, wine, juice and dairy products. Designed to comply with various sanitary approvals, these fittings are available in a range of styles such as BSM, CIP and triclover.

Specifically designed as a coupling system, the correctly engineered combination of hose and fitting will ensure trouble free operation suitable to your application whilst meeting statutory requirements.

Features:

- 304 stainless steel
- Meets FDA and USDA sanitary standards
- Flow Chief internal expansion (IX) fittings are only to be used with Flow Chief stainless steel ferrules.

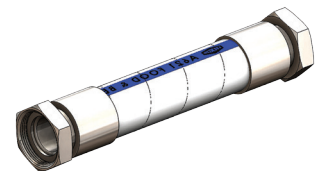

Contact Dixon™ for fluid transfer compatibility

CIP (IX) Hose Couplings

Meets  (3A), FDA and USDA sanitary standards. Clean-In-Place (CIP) compliant. Flow Chief internal expansion (IX) fittings are only to be used with Flow Chief stainless steel ferrules. Flow Chief Sanitary fittings are used in the food, dairy and beverage industries.

Sanitary Clamp End Stem		
Hose Size (inch)	Part No.	Price \$
1½	IXSE24-3A	326.79
2	IXSE32-3A	366.66
3	IXSE48-3A	445.12

Price Group: DS

AV01

Tube Weld End Stem		
Hose Size (inch)	Part No.	Price \$
2	IXPE32-3A	266.12

Price Group: DS

AV01

- Refer to pages 355-357 for sanitary style gaskets.
- Refer to pages 353 for sanitary style clamps.
- Special plug is required to expand 3A compliant fittings
- Special adaptor plate is required to expand 1½" 3A compliant fittings

