

V-Series Snap-Tite H/H Interchange Unvalved Couplers

Size (inch)	Part No.	Thread Size (inch)	Body Material	Weight (kg)	Pkg Qty		Price \$ (ea)
					Bag	Box	
¼	2VM2-E	¼ - 18 NPTF	Steel	0.09	5	50	101.05
¼	2VM2-B-E	¼ - 18 NPTF	Brass	0.09	5	50	116.46
¼	2VM2-SS-E	¼ - 18 NPTF	316 SS	0.09	5	50	177.61

Price Group: PC
AP11

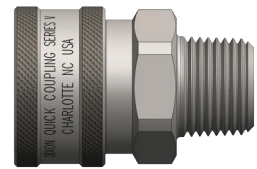

Male Thread

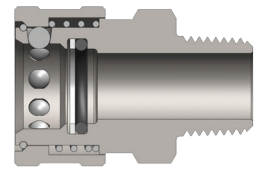

V-Series Snap-Tite H/H Interchange Unvalved Nipples

Size (inch)	Part No.	Male Thread Size (inch)	Body Material	Weight (kg)	Pkg Qty		Price \$ (ea)
					Bag	Box	
¼	V2M2-E	¼ - 18 NPTF	Steel	0.07	5	50	10.19
¼	V2M2-B-E	¼ - 18 NPTF	Brass	0.07	5	50	13.77
¼	V2M2-SS-E	¼ - 18 NPTF	316 SS	0.07	5	50	45.58
⅜	V3M3-E	⅜ - 18 NPTF	Steel	0.05	5	50	41.71
⅜	V3M3-B-E	⅜ - 18 NPTF	Brass	0.05	5	50	33.66
⅜	V3M3-SS-E	⅜ - 18 NPTF	316 SS	0.05	5	50	65.05
½	V4M4-E	½ - 14 NPTF	Steel	0.06	5	25	29.78
½	V4M4-B-E	½ - 14 NPTF	Brass	0.06	5	25	30.64
½	V4M4-SS-E	½ - 14 NPTF	316 SS	0.06	5	25	71.80
¾	V6M6-E	¾ - 14 NPTF	Steel	0.14	5	20	36.74
¾	V6M6-B-E	¾ - 14 NPTF	Brass	0.13	5	20	32.31
¾	V6M6-SS-E	¾ - 14 NPTF	316 SS	0.13	5	20	122.50
1	V8M8-E	1 - 11½ NPTF	Steel	0.18	-	10	46.75
1	V8M8-B-E	1 - 11½ NPTF	Brass	0.18	-	10	65.51
1	V8M8-SS-E	1 - 11½ NPTF	316 SS	0.18	-	10	162.38
1¼	V10M10-E	1¼ - 11½ NPTF	Steel	0.37	-	10	80.70
2	V16M16-SS-E	2 - 11½ NPTF	316 SS	0.65	-	5	228.97

Price Group: PC
AP11

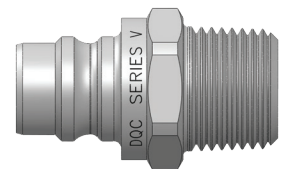

Male Thread

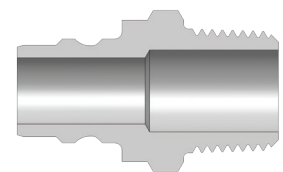

V-Series Dust Caps & Dust Plugs

Size (inch)	Part No.	Material	Pkg Qty		Price \$ (ea)
			Bag	Box	
⅜	3VDP-V3DC	Nitrile	10	50	6.34
½	4VDP-V4DC	Nitrile	10	50	9.46
¾	6VDP-V6DC	Nitrile	5	25	8.14
1	8VDP-V8DC	Nitrile	5	25	12.82

Price Group: PC
AP11



FOR TECHNICAL GUIDELINES PLEASE REFER TO PAGE 322



1300 134 651
dixonvalve.com.au

All prices exclude GST.
ADPL718