

V-Series Snap-Tite H/H Interchange Valved Nipples

| Size (inch) | Part No. | Thread Size (inch) | Body Material | Weight (kg) | Pkg Qty | | Price \$ (ea) |
|-------------|----------|--------------------|---------------|-------------|---------|-----|---------------|
| | | | | | Bag | Box | |
| ¼ | V2F1 | ¼ - 27 NPTF | Steel | 0.08 | 5 | 50 | 51.18 |
| ¼ | V2F2 | ¼ - 18 NPTF | Steel | 0.06 | 5 | 50 | 27.73 |
| ¼ | V2F2-B | ¼ - 18 NPTF | Brass | 0.06 | 5 | 50 | 34.97 |
| ¼ | V2F2-SS | ¼ - 18 NPTF | 316 SS | 0.07 | 5 | 50 | 136.47 |
| ¼ | V2BF2 | ¼ - 19 BSPP | Steel | 0.05 | 5 | 50 | 43.21 |
| ¼ | V2BF2-B | ¼ - 19 BSPP | Brass | 0.05 | 5 | 50 | 39.86 |
| ¼ | V2BF2-SS | ¼ - 19 BSPP | 316 SS | 0.05 | 5 | 50 | 96.72 |
| ¼ | V2OF2 | 7/16 - 20 ORB | Steel | 0.07 | 5 | 50 | 47.12 |
| ⅜ | V3F3-B | ⅜ - 18 NPTF | Brass | 0.10 | 5 | 50 | 66.81 |
| ⅜ | V3F3-SS | ⅜ - 18 NPTF | 316 SS | 0.10 | 5 | 50 | 157.53 |
| ⅜ | V3BF3 | ⅜ - 19 BSPP | Steel | 0.10 | 5 | 50 | 42.34 |
| ⅜ | V3BF3-B | ⅜ - 19 BSPP | Brass | 0.10 | 5 | 50 | 68.24 |
| ⅜ | V3BF3-SS | ⅜ - 19 BSPP | 316 SS | 0.10 | 5 | 50 | 120.55 |
| ⅜ | V3OF3 | 9/16 - 18 ORB | Steel | 0.11 | 5 | 50 | 56.57 |
| ⅜ | V3F4 | ½ - 14 NPTF | Steel | 0.12 | 5 | 50 | 58.32 |
| ½ | V4F4 | ½ - 14 NPTF | Steel | 0.14 | 5 | 25 | 36.83 |
| ½ | V4F4-SS | ½ - 14 NPTF | 316 SS | 0.14 | 5 | 25 | 218.69 |
| ½ | V4BF4 | ½ - 14 BSPP | Steel | 0.14 | 5 | 25 | 38.44 |
| ½ | V4BF4-B | ½ - 14 BSPP | Brass | 0.14 | 5 | 25 | 60.67 |
| ½ | V4BF4-SS | ½ - 14 BSPP | 316 SS | 0.14 | 5 | 25 | 160.17 |
| ½ | V4OF4 | ¾ - 16 ORB | Steel | 0.15 | 5 | 25 | 58.01 |
| ½ | V4F6 | ¾ - 14 NPTF | Steel | 0.17 | 5 | 25 | 58.52 |
| ¾ | V6F6 | ¾ - 14 NPTF | Steel | 0.27 | 5 | 20 | 57.97 |
| ¾ | V6F6-B | ¾ - 14 NPTF | Brass | 0.27 | 5 | 20 | 102.99 |
| ¾ | V6F6-SS | ¾ - 14 NPTF | 316 SS | 0.27 | 5 | 20 | 206.50 |
| ¾ | V6BF6 | ¾ - 14 BSPP | Steel | 0.27 | 5 | 20 | 59.76 |
| ¾ | V6BF6-B | ¾ - 14 BSPP | Brass | 0.27 | 5 | 20 | 95.80 |
| ¾ | V6BF6-SS | ¾ - 14 BSPP | 316 SS | 0.28 | 5 | 20 | 232.47 |
| ¾ | V6OF6 | 1 1/16 - 12 ORB | Steel | 0.30 | 5 | 20 | 97.06 |
| 1 | V8F8 | 1 - 11 1/2 NPTF | Steel | 0.42 | - | 10 | 111.44 |
| 1 | V8F8-B | 1 - 11 1/2 NPTF | Brass | 0.42 | - | 10 | 157.39 |
| 1 | V8F8-SS | 1 - 11 1/2 NPTF | 316 SS | 0.43 | - | 10 | 322.48 |
| 1 | V8BF8 | 1 - 11 BSPP | Steel | 0.42 | - | 10 | 116.28 |
| 1 | V8BF8-B | 1 - 11 BSPP | Brass | 0.43 | - | 10 | 167.95 |
| 1 | V8BF8-SS | 1 - 11 BSPP | 316 SS | 0.42 | - | 10 | 655.10 |
| 1 | V8OF8 | 1 1/8 - 12 ORB | Steel | 0.44 | - | 10 | 126.57 |

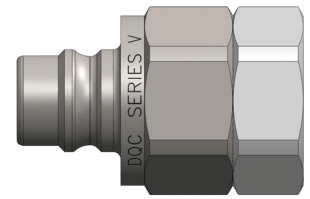

Female Thread

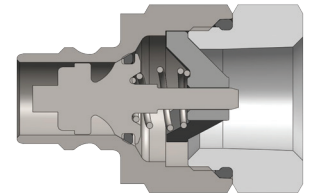

G

Price Group: PC

AP11

FOR TECHNICAL GUIDELINES PLEASE REFER TO PAGE 322



1300 134 651
dixonvalve.com.au

All prices exclude GST.
ADPL718