

K-Series Interchange - Nipples

Size (inch)	Part No.	Thread Size (inch)	Body Material	Weight (kg)	Pkg Qty		Price \$ (ea)
					Bag	Box	
¼	K2F1	⅛ - 27 NPTF	Steel	0.03	10	50	41.59
¼	K2F2	¼ - 18 NPTF	Steel	0.03	10	50	10.04
¼	K2F2-SS	¼ - 18 NPTF	316 SS	0.03	10	50	100.83
¼	K2BF2	¼ - 19 BSPP	Steel	0.03	10	50	10.05
¼	K2BF2-SS	¼ - 19 BSPP	316 SS	0.03	10	50	80.07
¼	K2OF2	⅞ - 20 ORB	Steel	0.03	10	50	109.06
⅜	K3F3	⅜ - 18 NPTF	Steel	0.05	10	50	15.03
⅜	K3F3-SS	⅜ - 18 NPTF	316 SS	0.06	10	50	105.73
⅜	K3BF3	⅜ - 19 BSPP	Steel	0.05	10	50	20.18
⅜	K3BF3-SS	⅜ - 19 BSPP	316 SS	0.06	10	50	112.79
⅜	K3OF3	⅞ - 18 ORB	Steel	0.06	10	50	44.94
⅜	K4F4-SS	⅞ - 18 ORB	316 SS	0.10	10	50	96.33
½	K4F4	½ - 14 NPTF	Steel	0.09	5	25	16.97
½	K4BF4	½ - 14 BSPP	Steel	0.09	5	25	17.56
½	K4BF4-SS	½ - 14 BSPP	316 SS	0.10	5	25	103.97
½	K4OF4	¾ - 16 ORB	Steel	0.10	5	25	31.72
½	K4OF5	⅞ - 14 ORB	Steel	0.09	5	25	34.07

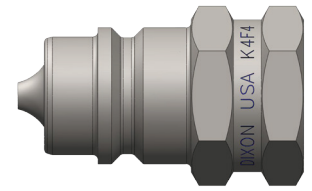

Female Thread

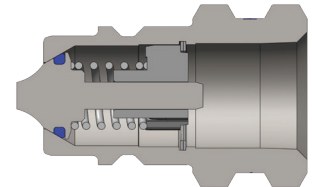

Price Group: PC
AP06

G

Size (inch)	Part No.	Thread Size (inch)	Body Material	Weight (kg)	Pkg Qty		Price \$ (ea)
					Bag	Box	
¾	K6F6	¾ - 14 NPTF	Steel	0.22	-	10	29.91
¾	K6F6-SS	¾ - 14 NPTF	316 SS	0.22	-	10	119.51
¾	K6BF6	¾ - 14 BSPP	Steel	0.22	-	10	33.28
¾	K6BF6-SS	¾ - 14 BSPP	316 SS	0.20	-	10	129.15
¾	K6OF6	1 ⅞ - 12 ORB	Steel	0.21	-	10	50.93
1	K8F8	1 - 11 ½ NPTF	Steel	0.34	-	10	47.87
1	K8F8-SS	1 - 11 ½ NPTF	316 SS	0.32	-	10	229.89
1	K8BF8	1 - 11 BSPP	Steel	0.34	-	10	49.62
1	K8BF8-SS	1 - 11 BSPP	316 SS	0.31	-	10	229.97
1	K8OF8	1 ⅞ - 12 ORB	Steel	0.33	-	10	76.05
1 ¼	K10F10	1 ¼ - 11 ½ NPT	Steel	0.57	-	10	102.57
1 ¼	K10BF10	1 ¼ - 11 BSPP	Steel	0.57	-	10	133.62
1 ½	K12F12	1 ½ - 11 ½ NPT	Steel	0.93	-	1	151.93
1 ½	K12BF12	1 ½ - 11 BSPP	Steel	0.93	-	1	151.93
2	K16F16	2 - 11 ½ NPT	Steel	1.65	-	1	265.86
2	K16BF16	2 - 11 BSPP	Steel	1.65	-	1	265.86



Female Thread

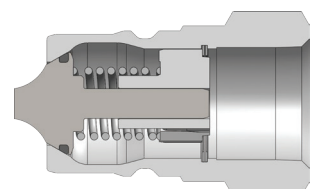

Price Group: PC
AP06

K-Series Profiles

Body Size (inch)	A (mm)	B (mm)
1/4	7/16	1/4
3/8	11/16	3/8
1/2	13/16	3/8
3/4	1 1/8	5/8
1	1 3/8	13/16
1-1/4	1-11/16	1
1-1/2	2-1/16	1-3/16
2	2-7/16	1-5/16

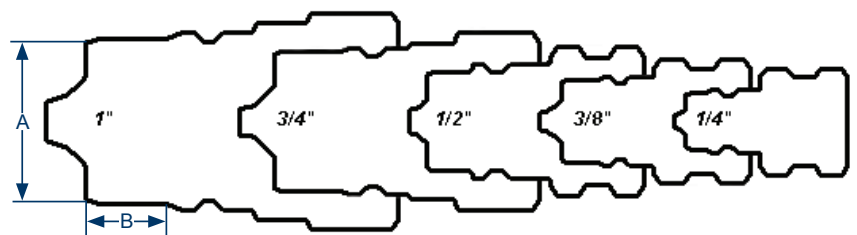

- NPTF & ORB thread styles also available.
- A complete range of seal options are available.

FOR TECHNICAL GUIDELINES PLEASE REFER TO PAGE 276



1300 134 651
dixonvalve.com.au

All prices exclude GST.
ADPL718