

N-Series Dix-Lock™

Application:	Used on large pneumatic hand-tools such as hammers, chippers, cable winders, air impact wrenches. Also widely used in refineries to convey air, water and nitrogen, for military applications such as breathing air, fresh air systems and oil rigs for compression jacks and hand tools.
Materials:	<ul style="list-style-type: none"> Machined components are manufactured using solid steel, brass, or 303 stainless steel bar stock. 316 stainless steel available in some versions upon request. Stainless Steel retaining ring and spring maximize corrosion resistance and extend service life. Steel comonetry is plated using ROHS Compliant Trivalent Chrome. Dust cap cable constructed of stainless steel Coupling sleeve constructed of cast zinc steel Steel and brass locking version have an aluminum lock ring while the stainless locking version has a stainless lock ring.
Seal Components:	Nitrile (Buna-N) pneumatically energized seals are standard, temperature range -40°C to 121°C.
Interchange Data:	<ul style="list-style-type: none"> Bowes Interchange Bayonet Style Interchangeable with Bowes 51000-Series, National Series 'B', MacDonald Quick-Action US Military MIL-C-3486 and US Government A-A50431A

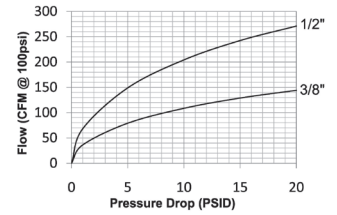

N-Series Bowes Interchange												
Body Size (inch)	Steel Coupler / Plug				Brass Coupler / Plug				303 Stainless Steel Coupler / Plug			
	Max Working		Coupled Burst		Max Working		Coupled Burst		Max Working		Coupled Burst	
	PSI	bar	PSI	bar	PSI	bar	PSI	bar	PSI	bar	PSI	bar
3/8	500	35	7,000	480	-	-	-	-	-	-	-	-
1/2	500	35	11,000	755	300	20	8,200	565	500	35	12,600	869

N-Series Dix-Lock™ Coupler

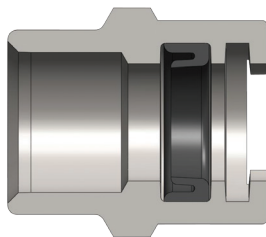

Female Thread

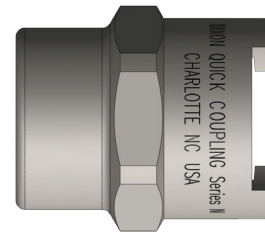

N-Series Bowes Interchange Coupler												
Body Size (inch)	Part No.	Threads (inch)	Material	Length		Maximum OD		Hex Size (inch)	Weight (kg)	Pkg Qty		Price \$ (ea)
				inch	mm	inch	mm			Bag	Box	
1/2	4NF3	3/8 - 18 NPTF	Steel	1.63	41.4	1.54	39.1	1%	0.23	-	25	48.09
1/2	4NF3-B	3/8 - 18 NPTF	Brass	1.63	41.4	1.54	39.1	1%	0.25	-	25	37.41
1/2	4NBF3	3/8 - 19 BSPPF	Steel	1.63	41.4	1.54	39.1	1%	0.23	-	25	35.00
1/2	4NF4	1/2 - 14 NPTF	Steel	1.63	41.4	1.54	39.1	1%	0.21	-	25	19.22
1/2	4NF4-B	1/2 - 14 NPTF	Brass	1.63	41.4	1.54	39.1	1%	0.23	-	25	30.98
1/2	4NBF4	1/2 - 14 BSPPF	Steel	1.63	41.4	1.54	39.1	1%	0.21	-	25	58.78
1/2	4NBF4-B	1/2 - 14 BSPPF	Brass	1.63	41.4	1.54	39.1	1%	0.23	-	25	53.30
1/2	4NF6	3/4 - 14 NPTF	Steel	1.63	41.4	1.54	39.1	1%	0.16	-	25	22.18
1/2	4NF6-B	3/4 - 14 NPTF	Brass	1.63	41.4	1.54	39.1	1%	0.19	-	25	28.11
1/2	4NF6-S	3/4 - 14 NPTF	303 SS	1.63	41.4	1.54	39.1	1%	0.17	-	25	98.37
1/2	4NBF6	3/4 - 14 BSPPF	Steel	1.63	41.4	1.54	39.1	1%	0.16	-	25	45.20
1/2	4NBF6-B	3/4 - 14 BSPPF	Brass	1.63	41.4	1.54	39.1	1%	0.19	-	25	71.26
1/2	4NF8	1 - 11 1/2 NPTF	Steel	1.68	42.6	1.73	43.9	1 1/2	0.22	-	25	44.30
1/2	4NF8-B	1 - 11 1/2 NPTF	Brass	1.68	42.6	1.73	43.9	1 1/2	0.24	-	25	66.05
1/2	4NBF8	1 - 11 BSPPF	Steel	1.68	42.6	1.73	43.9	1 1/2	0.22	-	25	38.95
1/2	4NBF8-B	1 - 11 BSPPF	Brass	1.68	42.6	1.73	43.9	1 1/2	0.24	-	25	51.49

Price Group: PC

AD07



It is important to be safe when installing quick disconnect couplings into a pneumatic circuit. Never install a pneumatic coupling directly into an air tool, use a piece of hose that is at least 18" long, between the tool and the coupling, to prevent damage to the coupling. To protect the operator, safety devices, such as a safety check valve and safety cable should be installed in case there is a hose or coupling failure.



1300 134 651
dixonvalve.com.au

All prices exclude GST.
ADPL718