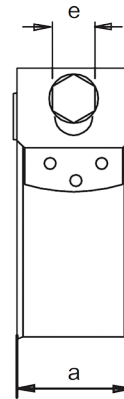
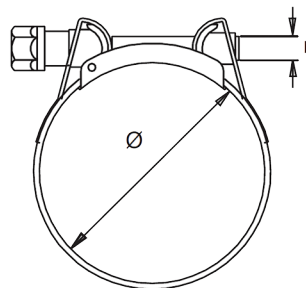

Mikalor Super Clamps - Stainless Steel - W4

Materials:

 Band and bridge: 304 stainless steel
 Bolt: 302 stainless steel

E

Hose OD Range		Part No.	Dimensions			Max Bolt Torque	Box Qty	Price \$ (ea)
From:	To:		r	e (mm)	a (mm)	Torque Nm		
17	19	SS019	M6	8	18	7	50	8.92
19	21	SS021	M6	8	18	7	50	9.04
21	23	SS023	M6	8	18	7	50	11.06
23	25	SS025	M6	8	18	7	50	9.30
25	27	SS027	M6	8	18	7	50	9.93
27	29	SS029	M6	8	18	7	50	11.11
29	31	SS031	M7	10	20	16	50	11.80
31	34	SS034	M7	10	20	16	50	12.45
34	37	SS037	M7	10	20	16	50	12.45
37	40	SS040	M7	10	20	16	50	12.12
40	43	SS043	M7	10	20	16	25	12.49
43	47	SS047	M7	10	20	16	25	17.66
47	51	SS051	M7	10	20	16	25	18.89
51	55	SS055	M7	10	20	16	25	19.00
55	59	SS059	M7	10	20	16	25	19.82
59	63	SS063	M7	10	20	16	25	19.27
63	68	SS068	M7	10	20	16	25	19.83
68	73	SS073	M8	13	25	25	25	26.77
73	79	SS079	M8	13	25	25	25	27.79
79	85	SS085	M8	13	25	25	25	29.35
85	91	SS091	M8	13	25	25	25	28.42
91	97	SS097	M8	13	25	25	25	29.13
97	104	SS104	M8	13	25	25	25	29.67
104	112	SS112	M8	13	25	25	10	30.02
112	121	SS121	M8	13	25	25	10	33.24
121	130	SS130	M8	13	25	25	10	33.72
130	140	SS140	M10	15	28	50	10	43.75
140	150	SS150	M10	15	28	50	10	50.31
150	162	SS162	M10	15	28	50	10	48.78
162	174	SS174	M10	15	28	50	10	48.10
174	187	SS187	M10	15	28	50	10	55.57
187	200	SS200	M10	15	28	50	10	54.00
200	213	SS213	M10	15	28	50	10	62.35
213	226	SS226	M10	15	28	50	10	45.11
226	239	SS239	M10	15	28	50	10	69.32
239	252	SS252	M10	15	28	50	10	59.50

Price Group: SD

AO10

