



# Vacuum Truck Product Brochure

1300 134 651 | [dixonvalve.com.au](http://dixonvalve.com.au)



## Your Trusted Partner in the **Vac Truck Market**

At Dixon, we recognise the vital role vacuum trucks serve across multiple industries, including environmental cleanups, industrial maintenance, and municipal services. Our comprehensive selection of premium hoses, camlocks, Travis fittings, industrial valves, clamps, and accessories is engineered to meet the diverse requirements of wet, dry, and combo vacuum trucks, guaranteeing efficiency, reliability, and safety in every operation.

### **Key Benefits of Partnering with Dixon:**

**Commitment to Quality and Innovation** Dixon is committed to delivering quality and innovative solutions tailored to the needs of the vacuum truck industry. Our products are tested to meet industry standards, ensuring they can withstand the toughest conditions and deliver exceptional performance.

**Solutions and Expert Support** At Dixon, we recognise that each vacuum truck operation has unique requirements. Our team works closely with customers to understand their specific needs and provide customised solutions that optimise performance and safety.

**Nationwide Distribution** Product availability is optimised through our six strategically located distribution centres across Australia.

### **Comprehensive Product Range**

- **Hose:** With a variety of options engineered to handle a diverse range of materials and conditions, our hoses ensure optimal performance and durability in both wet and dry vacuum applications.
- **Camlocks:** Boasting Australia's largest range, these quick-connect fittings provide secure, leak-free connections, allowing for swift setup and breakdown of vacuum systems, essential for maintaining operational efficiency.
- **Travis Fittings:** Known for their robust construction and versatility, Travis fittings are ideal for heavy-duty applications, ensuring long-lasting performance even under extreme conditions.
- **Industrial Clamps:** Our extensive range of clamps provides strong, reliable connections for hoses and fittings, ensuring secure operations in all vacuum truck applications.
- **Valves:** From a basic ball valve to a high-end actuated knife gate valves, our range enhances system control and customization, allowing for precise management of material flow and pressure, which is crucial for efficient vacuum operations.
- **Accessories:** Our range of accessories, including spray guns, moulded grip extensions, and turbo nozzles, enhances the functionality and versatility of your vacuum trucks, making them adaptable to a variety of tasks and improving overall efficiency.

# CONTENTS

<b>Industrial Hose</b> .....	<b>4</b>
Black Spiral HD 1800 AR Rubber HD Suction/Delivery (AUSKAR) .....	4
Green Spiral ABR Suction Hose (AUSGAR) .....	4
Yellow Spiral ABR PVC Delivery (AUSYTAR) .....	5
Petrol & Oil Suction/Delivery (AUSBHD) .....	5
Heavy-Duty Material Handling (A810) .....	6
Material Handling (A800) .....	6
Extra High Pressure Hot Water (PW206) .....	6
<b>Dixon™ Camlocks</b> .....	<b>7</b>
Type A - Adaptor x Female BSP .....	7
Type B - Coupler x Male BSP .....	7
Type C - Coupler x Hose Tail .....	7
Type D - Coupler x Female BSP .....	7
Type E - Adaptor x Hose Tail .....	7
Type F - Adaptor x Male BSP .....	7
Type DP - Dust Plug .....	8
Type DC - Dust Cap .....	8
Flange Adaptors .....	8
Flange Couplers .....	8
Type A Reducing .....	9
Type B Reducing .....	9
Type C Reducing .....	9
Type D Reducing .....	9
Type E Reducing .....	10
Type F Reducing .....	10
68° Deg Bend .....	10
Spool Couplers .....	10
Spool Adaptors .....	11
Type DA Reducing .....	11
Lockable Dust Caps .....	11
<b>Bauer Couplings</b> .....	<b>14</b>
<b>Travis Style Couplings</b> .....	<b>14</b>
<b>Industrial Clamps</b> .....	<b>15</b>
T-Bolt Super Clamps .....	15
Preformed Band Style Clamps .....	16
Band Clamp Hand Tools .....	16
Spiral Clamps .....	16
<b>Industrial Valves</b> .....	<b>17</b>
Brass Ball Valves .....	17
Quick Acting Gate Valves .....	17
Stainless Steel Knife Gate Valves .....	18
Wafer & Lugged Butterfly Valves .....	19
Wafer Pneumatic Actuated Butterfly Valves .....	19
<b>Spray Guns</b> .....	<b>20</b>
<b>Moulded Grip Extensions</b> .....	<b>21</b>
<b>Turbo Nozzles</b> .....	<b>19</b>

## Black Spiral Heavy Duty ABR Suction Hose (AUSKAR)

### Applications

- Manufactured with a high carbon content SBR blended tube which offers static dissipative properties and outstanding abrasion resistance. Designed to be lightweight with a corrugated outer cover for high flexibility and a smooth bore to reduce friction loss and build-up of residue. Perfect for vacuum truck applications as well as handling sands, rocks, grains, cement powders, iron chips, and other abrasive materials.

### Features

- Ozone & weather resistant
- Lightweight and flexible
- Abrasion resistant
- Extruded

### Hose Construction

- Tube: SBR blend - black
- Cover: SBR blend, corrugated - black
- Reinforcing: embedded rigid PVC helix

### Temperature

- -40°C to 60°C



Dimensions (mm)		Part Numbers		Working Pressure		Vacuum (bar)	Bend Radius (mm)	Weight (kg/mtr)
ID	OD	Cut Length	Coil 30m	psi	bar			
50.8	59.8	AUS050KARMTR	AUS050KAR030	40	3	1.0	65	0.75
63.5	74.5	AUS065KARMTR	AUS065KAR030	35	2	1.0	65	1.30
76.2	88.8	AUS080KARMTR	AUS080KAR030	35	2	1.0	75	1.63
101.6	117.6	AUS100KARMTR	AUS100KAR030	30	2	1.0	115	2.63
127.0	143.0	AUS125KARMTR	AUS125KAR030	30	2	1.0	125	3.67
152.4	171.0	AUS150KARMTR	AUS150KAR030	30	2	1.0	230	4.70

Cut length available in 10m increments

## Green Spiral ABR Suction Hose (AUSGAR)

### Applications

- Manufactured from a specially compounded rubber, designed to be lightweight with exposed rigid plastic helix for easy drag and a smooth bore to reduce friction loss and build up of residue. With excellent resistance to chemicals and oil making it perfect for vacuum truck applications for liquid waste, septic, sludge handling, chemical, dry material and grain transfer.

### Features

- Abrasion resistant
- Ozone and weather resistant
- Extruded

### Hose Construction

- Tube: EPDM blend - black
- Cover: black and green
- Reinforcing: exposed rigid PVC helix - green

### Temperature

- -40°C to +60°C

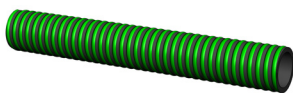

Dimensions (mm)		Part Numbers		Pressures			Vacuum (bar)	Bend Radius (mm)	Weight (kg/mtr)
ID	OD	Cut Length	Coil 30m	Working		Burst			
				psi	bar	psi			
38.1	42.1	AUS038GARMTR	AUS038GAR030	50	4	100	1.0	75	0.65
50.8	63.4	AUS050GARMTR	AUS050GAR030	50	4	100	1.0	125	1.10
63.5	79.6	AUS065GARMTR	AUS065GAR030	50	4	100	1.0	140	1.50
76.2	93.4	AUS080GARMTR	AUS080GAR030	43	3	86	1.0	180	1.80
101.6	118.0	AUS100GARMTR	AUS100GAR030	38	3	76	0.9	280	2.90

Cut length available in 10m increments

## Yellow Spiral ABR PVC Suction Hose (AUSYTAR)

### Applications

- A robust suction and discharge hose well suited for use in harsh environments. Especially well suited for use with abrasive slurries, waste and many chemicals in vacuum truck applications.

### Features

- Abrasion resistant
- Ozone and weather resistant
- Extruded

### Hose Construction

- Tube: PVC/NBR blend - black
- Cover: black and yellow
- Reinforcing: exposed rigid PVC helix - yellow

### Temperature

- -5°C to +60°C

Dimensions (mm)		Part Numbers	Pressures				Vacuum (bar)	Bend Radius (mm)	Weight (kg/mtr)
ID	OD		Working		Burst				
		Coil 20m	psi	bar	psi	bar			
50.8	63.4	AUS050YTAR020	73	5.0	146	10.0	1.0	350	1.10
63.5	79.6	AUS065YTAR020	58	4.0	116	8.0	1.0	380	1.50
76.2	93.4	AUS076YTAR020	58	4.0	116	8.0	1.0	400	1.80
101.6	118.0	AUS100YTAR020	43	3.0	86	6.0	1.0	600	2.90



## Petrol & Oil Suction/Delivery Hose (AUSBHD)

### Applications

- Heavy-duty suction and delivery of oils, oil slurry, grease, diesel fuel, light chemicals and lubricants. Particularly suited for liquid waste transfer, grease trap and septic tank cleaning applications.

### Features

- Abrasion resistant
- Oil mist resistant
- High impact resistance
- UV stabilised
- Extruded

### Hose Construction

- Tube: smooth PVC/NBR blend - blue
- Reinforcing: rigid PVC embedded helix - blue
- Cover: smooth PVC/NBR blend, smooth - blue

### Temperature

- -40°C to 65°C

Dimensions (mm)		Part Numbers		Working Pressure		Vacuum (bar)	Bend Radius (mm)	Weight (kg/mtr)
ID	OD	Cut Length	Coil 20m	psi	bar			
25.4	31.5	-	AUS025BHD020	90	6	1.0	75	0.39
31.8	39.1	-	AUS032BHD020	80	5.5	1.0	105	0.51
38.1	46.2	-	AUS040BHD020	75	5	1.0	155	0.65
50.8	60.7	AUS050BHD	AUS050BHD020	75	5	1.0	205	1.10
63.5	74.4	AUS065BHD	AUS065BHD020	75	5	1.0	255	1.50
76.2	87.1	AUS076BHD	AUS076BHD020	60	4	1.0	305	1.80
101.6	115.1	AUS100BHD	AUS100BHD020	50	3.5	1.0	380	3.00
152.4	169.4	AUS150BHD	AUS150BHD020	30	2	1.0	635	5.51

Cut length available in 10m increments

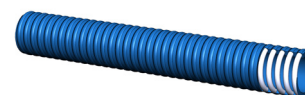

## Material Handling Hose

### Applications

- Manufactured from top-quality hevea red rubber compound renowned for its exceptional abrasion resistance, this hose boasts remarkable flexibility, rendering it ideal for efficiently extracting and transporting highly abrasive substances like stones, sand, gravel, powdered materials, sludge, and more. Primarily employed alongside vacuum trucks in hose reel “cassette” setups, it also excels in boom applications.

### Features

- Abrasion resistant
- Ozone & weather resistant
- UV stabilised
- Oil mist resistant

### Hose Construction

- Tube: Hevea ABR rubber - red
- Cover: SBR/EPDM blend, corrugated - black
- Reinforcing: high tensile synthetic textile cords, single wire helix

### Temperature

- -35°C to 80°C



Heavy-Duty Material Handling A810

Dimensions (mm)		Part Numbers		Pressures				Bend Radius (mm)	Weight (kg/mtr)
ID	OD	Coil 6.5m	Coil 20m	Working		Burst			
				psi	bar	psi	bar		
101.6	116.0	A810100006	A810100020	45	3	135	9	400	3.25
127.0	141.0	A810125006	A810125020	45	3	135	9	540	4.60
152.4	166.0	A810150006	A810150020	45	3	135	9	690	6.30
203.2	217.0	A810200006	A810200020	45	3	135	9	1000	9.60

### Hose Construction

- Tube: smooth NR/SBR - black
- Cover: SBR/EPDM blend, smooth - black
- Reinforcing: high tensile synthetic textile cords, single wire helix

### Temperature

- -30°C to 70°C



Material Handling A800

Dimensions (mm)		Part Numbers		Pressures				Bend Radius (mm)	Weight (kg/mtr)
ID	OD	Cut Length	Coil 20m	Working		Burst			
				psi	bar	psi	bar		
101.6	129.0	A800100	A800100020	150	10	435	30	711	7.10
127.0	156.0	A800125	A800125020	150	10	435	30	889	8.90
152.4	182.0	A800150	A800150020	150	10	435	30	1067	10.70
203.2	235.0		A800200020	150	10	435	30	1421	14.20

## Extra High Pressure Hot Water Wash Hose (PW206)

### Applications

- An exceptionally durable, steel-braided delivery hose designed for maximum flexibility, lightweight handling, and ease of use. Specifically engineered for conveying high-temperature, high-pressure hot water, cold water, and detergent solutions, it is ideal for use with heavy-duty, high-pressure cleaning equipment.

### Features

- Ozone & weather resistant
- Hot water & detergent resistant
- Abrasion resistant
- Oil resistant
- Extruded

### Hose Construction

- Tube: synthetic rubber - black
- Cover: synthetic rubber, smooth - blue
- Reinforcing: high tensile steel wire braids

### Temperature

- -40°C to 150°C



Dimensions (mm)		Part Number	Pressures			Bend Radius (mm)	Weight (kg/mtr)
ID	OD		Working		Burst		
			psi	bar	psi		
9.5	18.0	PW206	5800	40	29000	160	0.53

## Dixon™ Camlocks

### Application

- The Dixon™ standard camlock, ideal for the demanding vac truck market, is a durable and economical camlock that is designed for quick and easy connection and disconnection. Trust in Dixon™ camlocks to deliver unmatched reliability and performance in vac truck applications, built to withstand the rigours of heavy-duty operations.

### Materials

- Body: cast aluminium equivalent to ASTM A383 or stainless steel CF8M (316 Equivalent)
- Levers: stainless steel
- Pins: zinc plated steel
- Pull Rings: zinc plated steel
- Seal: Nitrile Buna-N rubber

### Specifications

- Interchangeable with all products produced to commercial description A-A-59326D

### Connections

- Camlock adaptor and coupler
- BSP female and male
- Standard hose tail

### Aluminium



Size (mm)	Working Pressure (psi)	Part Numbers					
		Type A	Type B	Type C	Type D	Type E	Type F
		Adaptor x Female BSP	Coupler x Male BSP	Coupler x Hose Tail	Coupler x Female BSP	Adaptor x Hose Tail	Adaptor x Male BSP
20	250	EAL075A	EAL075B	EAL075C	EAL075D	EAL075E	EAL075F
25	250	EAL100A	EAL100B	EAL100C	EAL100D	EAL100E	EAL100F
32	250	EAL125A	EAL125B	EAL125C	EAL125D	EAL125E	EAL125F
40	250	EAL150A	EAL150B	EAL150C	EAL150D	EAL150E	EAL150F
50	250	EAL200A	EAL200B	EAL200C	EAL200D	EAL200E	EAL200F
65	150	EAL250A	EAL250B	EAL250C	EAL250D	EAL250E	EAL250F
75	125	EAL300A	EAL300B	EAL300C	EAL300D	EAL300E	EAL300F
100	100	EAL400A	EAL400B	EAL400C	EAL400D	EAL400E	EAL400F
150	75	EAL600A	EAL600B	EAL600C	EAL600D	EAL600E	EAL600F

### Stainless Steel



Size (mm)	Working Pressure (psi)	Part Numbers					
		Type A	Type B	Type C	Type D	Type E	Type F
		Adaptor x Female BSP	Coupler x Male BSP	Coupler x Hose Tail	Coupler x Female BSP	Adaptor x Hose Tail	Adaptor x Male BSP
20	250	ESS075A	ESS075B	ESS075C	ESS075D	ESS075E	ESS075F
25	250	ESS100A	ESS100B	ESS100C	ESS100D	ESS100E	ESS100F
32	250	ESS125A	ESS125B	ESS125C	ESS125D	ESS125E	ESS125F
40	250	ESS150A	ESS150B	ESS150C	ESS150D	ESS150E	ESS150F
50	250	ESS200A	ESS200B	ESS200C	ESS200D	ESS200E	ESS200F
65	150	ESS250A	ESS250B	ESS250C	ESS250D	ESS250E	ESS250F
75	125	ESS300A	ESS300B	ESS300C	ESS300D	ESS300E	ESS300F
100	100	ESS400A	ESS400B	ESS400C	ESS400D	ESS400E	ESS400F

## Dixon™ Camlocks



Size (mm)	Part Numbers			
	Type DP - Dust Plug		Type DC - Dust Cap	
	Aluminium	Stainless Steel	Aluminium	Stainless Steel
20	EAL075DP	ESS075DP	EAL075DC	ESS075DC
25	EAL100DP	ESS100DP	EAL100DC	ESS100DC
32	EAL125DP	ESS125DP	EAL125DC	ESS125DC
40	EAL150DP	ESS150DP	EAL150DC	ESS150DC
50	EAL200DP	ESS200DP	EAL200DC	ESS200DC
65	EAL250DP	ESS250DP	EAL250DC	ESS250DC
75	EAL300DP	ESS300DP	EAL300DC	ESS300DC
100	EAL400DP	ESS400DP	EAL400DC	ESS400DC
150	EAL600DP	-	EAL600DC	-

## Dixon™ Flange Adaptor

Adaptor x Flange - Drilled Table D/E



Size (mm)	Working Pressure (psi)	Part Numbers	
		Aluminium	Stainless Steel
25	250	-	100-LA-SS
40	250	-	150-LA-SS
50	250	200-LA-AL	200-LA-SS
75	125	300-LA-AL	300-LA-SS
100	100	400-LA-AL	400-LA-SS
150	75	600-LA-AL	600-LA-SS

Also available in ANSI 150#

## Dixon™ Flange Coupler

Coupler x Flange - Drilled Table D/E



Size (mm)	Working Pressure (psi)	Part Numbers	
		Aluminium	Stainless Steel
25	250	-	100-LD-SS
40	250	-	150-LD-SS
50	250	200-LD-AL	200-LD-SS
75	125	300-LD-AL	300-LD-SS
100	100	400-LD-AL	400-LD-SS
150	75	600-LD-AL	600-LD-SS

Also available in ANSI 150#



- Under no circumstances should camlock couplings be used in compressed air or steam applications
- Dust caps and dust plugs are not to be used in any pressure applications for safety and environmental reasons



## Dixon™ Reducing Type A

### Adaptor x Female BSP

Size (mm)		Working Pressure (psi)	Part Numbers	
adaptor	bsp		Aluminium	Stainless Steel
50	40	250	2015-A-ALA	2015-A-SSA
50	75	125	2030-A-ALA	2030-A-SSA
75	50	125	3020-A-ALA	3020-A-SSA
75	100	100	3040-A-ALA	3040-A-SSA
100	75	100	4030-A-ALA	4030-A-SSA
100	150	75	4060-A-ALA	4060-A-SSA
150	100	75	-	6040-A-SSA



## Dixon™ Reducing Type B

### Coupler x Male BSP

Size (mm)		Working Pressure (psi)	Part Numbers	
coupler	bsp		Aluminium	Stainless Steel
40	25	250	1510-B-ALA	1510-B-SSA
50	40	250	2015-B-ALA	2015-B-SSA
50	75	250	2030-B-ALA	2030-B-SSA
75	50	125	3020-B-ALA	3020-B-SSA
75	100	125	3040-B-ALA	3040-B-SSA
100	75	100	4030-B-ALA	4030-B-SSA



## Dixon™ Reducing Type C

### Coupler x Hose Tail

Size (mm)		Working Pressure (psi)	Part Numbers	
coupler	tail		Aluminium	Stainless Steel
50	40	250	2015-C-AL	2015-C-SS
75	50	125	3020-C-AL	3020-C-SS
75	100	125	3040-C-AL	3040-C-SS
100	75	100	4030-C-AL	4030-C-SS
125	100	75	5040-C-AL	5040-C-SS



## Dixon™ Reducing Type D

### Coupler x Female BSP

Size (mm)		Working Pressure (psi)	Part Numbers	
coupler	bsp		Aluminium	Stainless Steel
40	25	250	1510-D-ALA	1510-D-SSA
50	40	250	2015-D-ALA	2015-D-SSA
75	50	125	3020-D-ALA	3020-D-SSA
100	75	100	4030-D-ALA	4030-D-SSA



# Camlocks - Reducing Adaptors & Couplers

## Dixon™ Reducing Type E



Adaptor x Hose Tail

Size (mm)		Working Pressure (psi)	Part Numbers	
adaptor	tail		Aluminium	Stainless Steel
50	40	250	2015-E-AL	2015-E-SS
75	50	125	3020-E-AL	3020-E-SS
100	75	100	4030-E-AL	4023-E-SS
125	100	75	5040-E-AL	-

## Dixon™ Reducing Type F



Adaptor x Male BSP

Size (mm)		Working Pressure (psi)	Part Numbers	
adaptor	bsp		Aluminium	Stainless Steel
40	50	250	1520-F-ALA	-
50	40	250	2015-F-ALA	2015-F-SSA
50	75	250	2030-F-ALA	-
75	40	125	3015-F-ALA	3015-F-SSA
75	50	125	3020-F-ALA	3020-F-SSA
75	100	125	3040-F-ALA	-
100	75	100	4030-F-ALA	4030-F-SSA

## Dixon™ Bend 68°



Coupler x Hose Tail

Size (mm)	Working Pressure (psi)	Part Numbers	
		Aluminium	Brass
50	250	20-C68-AL	-
65	150	25-C68-AL	25-C68-BR
75	125	30-C68-AL	30-C68-BR
100	100	40-C68-AL	40-C68-BR

## Dixon™ Spool Coupler



Coupler x Coupler

Size (mm)		Working Pressure (psi)	Part Numbers	
coupler	coupler		Aluminium	Stainless Steel
50	50	250	200-DD-AL	200-DD-SS
50	75	125	2030-DD-AL	2030-DD-SS
75	75	125	300-DD-AL	300-DD-SS
75	100	100	3040-DD-AL	-
100	100	100	400-DD-AL	400-DD-SS



- Under no circumstances should camlock couplings be used in compressed air or steam applications
- Dust caps and dust plugs are not to be used in any pressure applications for safety and environmental reasons

## Dixon™ Spool Adaptor

### Adaptor x Adaptor

Size (mm)		Working Pressure (psi)	Part Numbers		
adaptor	adaptor		Aluminium	Bronze	Stainless Steel
25	25	250	100-AA-AL	100-AA-BR	100-AA-SS
32	32	250	125-AA-AL	125-AA-BR	125-AA-SS
40	40	250	150-AA-AL	150-AA-BR	150-AA-SS
40	50	250	1520-AA-AL	--	1520-AA-SS
50	50	250	200-AA-AL	200-AA-BR	200-AA-SS
50	75	125	2030-AA-AL	-	2030-AA-SS
65	65	150	250-AA-AL	-	-
65	75	125	2530-AA-AL	-	2530-AA-SS
65	100	100	2540-AA-AL	-	-
75	75	125	300-AA-AL	300-AA-BR	300-AA-SS
75	100	100	3040-AA-AL	-	3040-AA-SS
100	100	100	400-AA-AL	400-AA-BR	400-AA-SS
100	125	75	4050-AA-AL	-	-
100	150	75	4060-AA-AL	-	4060-AA-SS
150	150	75	600-AA-AL	-	600-AA-SS



## Dixon™ Reducing Type DA

### Coupler x Adaptor

Size (mm)		Working Pressure (psi)	Part Numbers
coupler	adaptor		Aluminium
40	25	250	1510-DA-AL
40	50	250	1520-DA-AL
50	40	250	2015-DA-AL
50	75	125	2030-DA-AL
50	100	100	2040-DA-AL
75	40	125	3015-DA-AL
75	50	125	3020-DA-AL
75	100	100	3040-DA-AL
100	50	100	4020-DA-AL
100	75	100	4030-DA-AL
100	150	100	4060-DA-AL
150	75	75	6030-DA-AL
150	100	75	6040-DA-AL
150	125	75	6050-DA-AL



## Dixon™ Lockable Dust Caps

Size		Part Numbers		
mm	inch	Aluminium	Bronze	Stainless Steel
40	1½	-	-	150DC-SSL
50	2	AL200DC-L	BR200DC-L	200DC-SSL
75	3	AL300DC-L	BR300DC-L	300DC-SSL
100	4	AL400DC-L	BR400DC-L	400DC-SSL
150	6	AL600DC-L	-	-



Aluminium



Stainless Steel

# Benefits of a Distributor Account



**SCAN** to sign up for an online Distributor Account



Check **Pricing**

Check **Stock Availability**

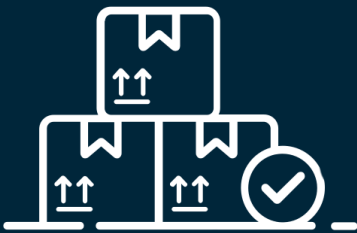

**Bulk Order** Upload

**Place** Your Order



View **Orders & Invoices**

Stay  
**Connected**  
With Us!

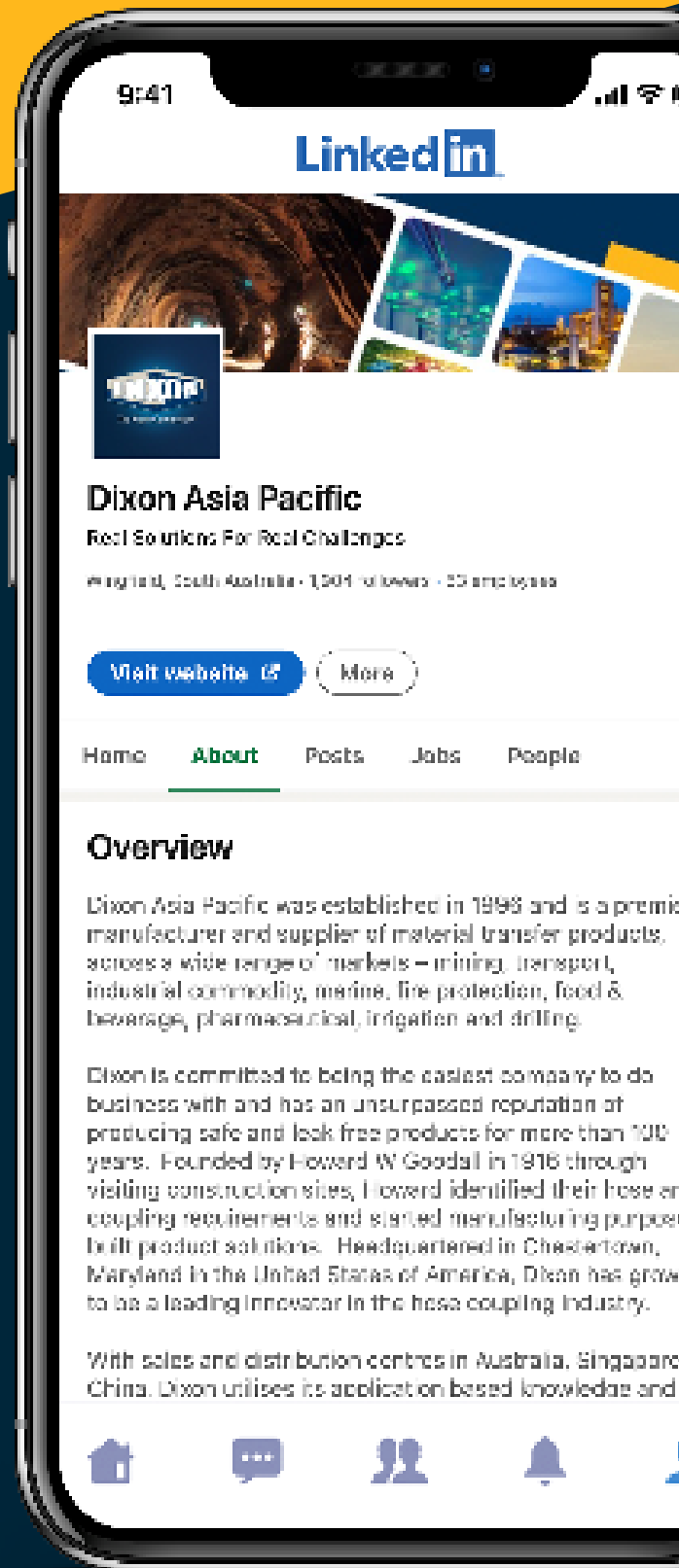

Follow  
**@ DixonAsiaPacific**

# Industrial Products - Couplings

## Bauer Style Couplings



Size		Part Numbers			
mm	inch	Lever Ring	Male Spigot	Female Spigot	Full Set
50	2	LR3042	100050	101050	50BSET
80	3	LR3043	100075	101075	75BSET
100	4	LR3044	100100	101100	100BSET
125	5	104125	100125	101125	125BSET
150	6	LR3046	100150	101150	150BSET
200	8	LR3048	100200	101200	200BSET

Rubber O-ring not included with the female spigot



Size		Part Numbers				
mm	inch	Male Flange	Female Flange	Weld-On Male	Weld-On Female	O-Ring
80	3	102075	103075	3033	111075	RG3053
100	4	102100	103100	3034	111100	RG3054
125	5	102125	103125	-	-	105127
150	6	102150	103150	3036	111150	RB3056
200	8	102200	103200	3038	111200	RG3058

Rubber O-ring not included with the weld-on female

## Travis Style Couplings



Size		Part Numbers			
mm	inch	Male Spigot	Female Spigot	Closure Ring	Full Set
100	4	TC100M	TC100F	TC100CR	TC100SET
125	5	TC125M	TC125F	TC125CR	TC125SET
150	6	TC150M	TC150F	TC150CR	TC150SET
200	8	TC200M	TC200F	TC200CR	TC200SET

Cup seal included with the female spigot



Size		Part Numbers			
mm	inch	Reducing Adaptor	Male O-Ring	Female Cup Seal	Blanking Plug
100	4	TC125100RA	TC100MS	TC100FS	TC100BP
125	5	TC150125RA	TC125MS	TC125FS	TC125BP
150	6	TC150100RA	TC150MS	TC150FS	TC150BP
200	8	TC200150RA	TC200MS	TC200FS	TC200BP

## T-Bolt Super Clamps - W4

### Features

- Complies with the RoHS directive EU 20032/95/EC 2006
- Swiveling bridge
- Can be opened up & fastened again when in place without dislodging other parts of the clamp
- Bevelled edges to protect the hose from damage

### Materials

- Band & bridge - 304 series stainless steel
- Bolt - 302 stainless steel

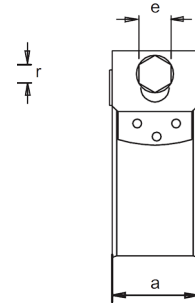
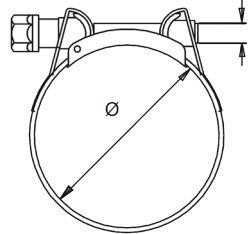

Hose OD Range		Part Numbers	Dimensions (mm)			Bolt Torque (Nm)	Box Quantity
from	to		r	e	a		
17	19	SS019	M6	8	18	10	50
19	21	SS021	M6	8	18	10	50
21	23	SS023	M6	8	18	10	50
23	25	SS025	M6	8	18	10	50
23	27	SS027	M6	8	18	10	50
27	29	SS029	M7	11	20	10	50
29	31	SS031	M7	11	20	12	50
31	34	SS034	M7	11	20	12	50
34	37	SS037	M7	11	20	12	50
37	40	SS040	M7	11	20	12	50
40	43	SS043	M7	11	20	12	50
43	47	SS047	M7	11	20	12	50
47	51	SS051	M7	11	20	16	50
51	55	SS055	M7	11	20	16	25
55	59	SS059	M7	11	20	16	25
59	63	SS063	M7	11	20	16	25
63	68	SS068	M7	11	20	16	25
68	73	SS073	M8	13	25	30	25
73	79	SS079	M8	13	25	30	25
79	85	SS085	M8	13	25	30	25
85	91	SS091	M8	13	25	30	25
91	97	SS097	M8	13	25	30	25
97	104	SS104	M8	13	25	30	25
104	112	SS112	M8	13	25	30	25
112	121	SS121	M8	13	25	30	25
121	130	SS130	M8	13	25	30	25
130	140	SS140	M10	15	28	45	10
140	150	SS150	M10	15	28	45	10
150	162	SS162	M10	15	28	45	10
162	174	SS174	M10	15	28	45	10
174	187	SS187	M10	15	28	45	10
187	200	SS200	M10	15	28	45	10
200	213	SS213	M10	15	28	45	10
213	226	SS226	M10	15	28	45	10
226	239	SS239	M10	15	28	45	10
239	252	SS252	M10	15	28	45	10



## Universal Preformed Band Style Clamps



### Features

- Install with centre punched or rolled-over tools
- Fast-Lok tools F1, F40 & F100
- Super strap tools 51960 screw action with 51970 adapter
- Punch-Lok tools P-1000 or P-38 for 3/8" & 5/8", P-3000 for 3/8"

### Materials

- Band - 300 series stainless steel
- Buckles - 201 series stainless steel



Clamp ID		Part Numbers		Band Width (mm)	Box Quantity
mm	inch	K-Series			
65	2½	KS10M		16	50
70	2¾	KS11M		16	50
76	3	KS12M		16	50
92	3½	KS14M		16	50
100	4	KS16M		16	25
112	4½	KS18M		16	25
125	5	KS20M		16	25
150	6	KS24M		16	25
175	7	KS28M		16	25
200	8	KS32M		16	25

## Band Clamp Hand Tools



Part Number	Description
F1	Hand tool for application of 3/8" band clamps

## Spiral Clamps

### Application

- Clockwise and anti-clockwise clamps are used for securing convoluted cover hoses, which are hoses with a spiral or corrugated outer cover. The spiral clamp is specifically designed to fit between the corrugations of the hose cover, providing a secure and tight grip on the hose.

### Features

- Use on convoluted cover hose
- Clockwise wound or anti-clockwise wound

### Materials

- Carbon steel band CW15 DIN 1-114 1
- Zinc-plated chromate/passivated

### Notes

- To determine which style clamp is needed for your hose, look at the end of the hose, if the helix spirals in a clockwise direction away from you (along the hose), a clockwise clamp is needed
- More than one clamp may be needed per size, contact Dixon customer service



Hose ID		Hose OD (mm)		Part Numbers		Box Quantity
mm	inch	from	to	Clockwise	Anti-Clockwise	
38	1½	38.8	46	SC150	-	100
50	2	57.9	63.5	SC200	SCCW200	100
65	2½	69	73	SC250	SCCW250	50
76	3	80	88.9	SC300	SCCW300	50
100	4	100	114.3	SC400	SCCW400	50
125	5	129.4	139.7	SC500	SCCW500	20
150	6	158.7	177.8	SC600	SCCW600	20
200	8	215.9	234.95	SC800	-	20



## Brass Ball Valve - General Purpose

### Application

- Recommended for general use with water, oil & gas.

### Design

- Robust in construction
- Blow-out proof stem design

### Material

- Body: nickel-plated brass with stainless steel handle
- Seat: PTFE
- Ball: chrome-plated brass
- Teflon seats, packing, and thrust washer

### End Connection

- Female x female BSP

### Operating Temperature

- -10°C - 110°C

### Notes

- Quarter turn is "ON" or "OFF"
- The valve is fully open when the handle is parallel to the valve body
- Quarter turn the valve clockwise to make it fully shutoff

Size		Part Numbers	Working Pressure		Weight (kg)
mm	inch		PSI	Bar	
6	¼	BBVSTD006SS	362	25	0.12
10	⅜	BBVSTD010SS	362	25	0.12
15	½	BBVSTD012SS	362	25	0.20
20	¾	BBVSTD020SS	362	25	0.30
25	1	BBVSTD025SS	362	25	0.43
32	1¼	BBVSTD032SS	362	25	0.83
40	1½	BBVSTD040SS	362	25	0.95
50	2	BBVSTD050SS	362	25	2.05
65	2½	BBVSTD065SS	362	25	3.84
80	3	BBVSTD075SS	200	16	5.39
100	4	BBVSTD100SS	200	16	7.36



## Quick Acting Gate Valve

### Application

- Used for quick discharge and shut off for water, air, gas, and fluids that are compatible with valve body & trim.

### Features

- Anticlog
- Full flow

### Material

- Body: brass
- Seat & stem: brass

### Working Pressure

- DN80 & DN100: 145 PSI (10 bar)
- DN150: 116 PSI (8 bar)

### End Connection

- Female BSP (ISO 228/1)
- Female NPT (ANSI B1.20.1)

### Temperature

- -20°C (without liquid) to 90°C

### Available Options

- Valve with square flange/threaded configuration

Size		Part Numbers	
mm	inch	NPT	BSP
80	3	GV-QA-080	GV-QA-080B
100	4	GV-QA-100	GV-QA-100B
150	6	GV-QA-150	GV-QA-150B



## Stainless Steel Knife Gate Valves

### Application

- The Dixon™ VKG series is a robust uni-directional stainless steel knife gate valve. The unique design of the VKG series is perfect for low-pressure applications. Double-row thrust bearings for smooth operation and a hardened chrome-plated 316 stainless steel gate with a PTFE seat, provides the VKG series with the strength and diversity to handle a multitude of applications.

### Features

- Size range DN50 - DN1200
- A special replaceable seat
- Roller bearings in stainless steel housing on all sizes
- Fully lugged to suit AS4087 Class 16, Table D
- Stainless steel stem protection tube
- Gearbox included on DN450 and above
- Stainless steel safety guards
- Special adjustable gate guide ensures no leakage
- PTFE seat as standard
- Temperature range up to 200°C (depending on seat)

### Dixon Brand Manual (hand wheel operated)

- Include stainless steel gate guard & stainless steel stem cover as standard

### Dixon Brand Actuated (double acting)

- Includes 24VDC solenoid valve, proximity switches & air filter regulator as standard

### Pressure Rating

- DN50 to DN250 - 10 Bar (150 PSI)
- DN300 to DN450 - 7 Bar (90 PSI)
- DN500 to DN600 - 4 Bar (60 PSI)

### Maximum Temperature Rating

- 180°C PTFE (standard)
- 200°C Viton (optional)
- 120°C EPDM (optional)
- 90°C NBR (optional)
- 200°C Metal (selected sizes)

### Approvals

- MSS SP-81

Size		Part Numbers	
mm	inch	Hand Wheel	Double Acting Lugged T/D
80	3	VKG-080-RS-SS	VKG-080-SS-ACT
100	4	VKG-100-RS-SS	VKG-100-SS-ACT
150	6	VKG-150-RS-SS	VKG-150-SS-ACT
200	8	VKG-200-RS-SS	VKG-200-SS-ACT
250	10	VKG-250-RS-SS	VKG-250-SS-ACT

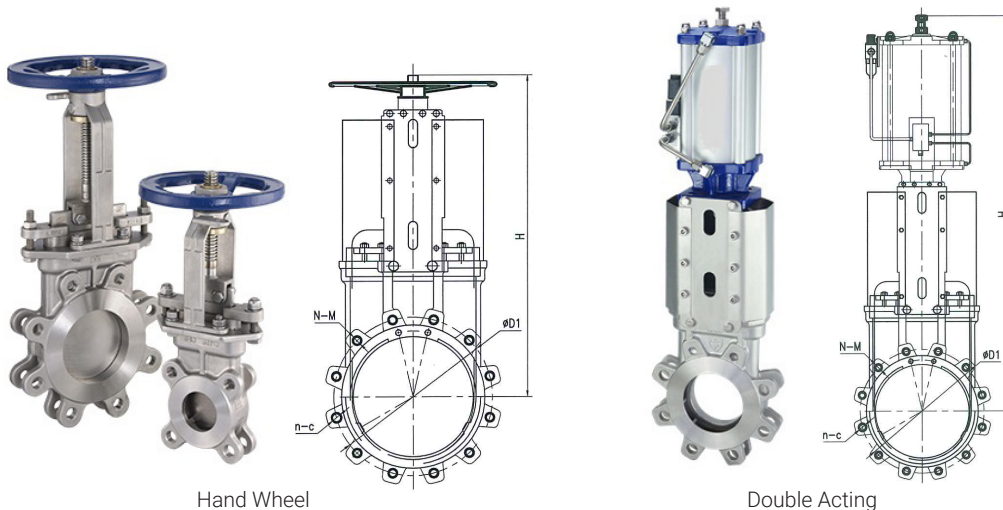

DN	L	Ød	ØD1	D2	N-M	n-c	H	
							Hand Wheel	Double Acting
80	51	90	146	122	2-M16	2-Ø18	365	-
100	51	105	178	154	2-M16	2-Ø18	410	610
150	57	158	235	211	2-M16	6-Ø18	505	760
200	70	210	292	266	2-M16	6-Ø18	615	950
250	70	210	356	319	2-M20	6-Ø22	740	1135

## Wafer & Lugged Butterfly Valves

### Application

- Suitable for water, wastewater, hydrocarbons, some chemicals and fluids that are compatible with the trim and seat material.

### Features

- Lever or gear operated, ISO 5211 mounted for actuation

### End Connection

- Wafer fits Table E & ANSI 150/125 & PN16
- Lugged Table E

### Working Pressure

- 232 PSI (16 bar)

### Material

- Body: cast iron
- Trim: 316 stainless steel
- Seat: EPDM standard. Nitrile Buna, FKM & PTFE available on request

### Available Options

- <sup>1</sup>ANSI150 available
- <sup>2</sup>Gearbox operated
- \*Available on request

Size		Part Numbers			Face-to-Face (mm)
mm	inch	Lugged Table E <sup>1</sup>	Wafer EPDM Seat	Wafer NBR Seat	
50	2	LSSE050H	VBF-IBFW050	WDSE050H	43
65	2½	LSSE065H	VBF-IBFW065	WDSE065H	46
80	3	LSSE080H	VBF-IBFW080	WDSE080H	46
100	4	LSSE100H	VBF-IBFW100	WDSE100H	52
125	5	LSSE125H	VBF-IBFW125	WDSE125H	56
150	6	LSSE150H	VBF-IBFW150	WDSE150H	56
200	8	LSSE200H	VBF-IBFW200	WSSE200H	60



## Wafer Pneumatic Actuated Butterfly Valves

### Application

- Most fluid applications and air or gas that are compatible with the valve, body and trim. Not suitable for dry applications.

### Features

- Wafer type ISO 5211
- Direct mounted
- Minimum external air pressure 80 PSI (5.5 bar)

### End Connection

- Wafer universal suits table D/E, ANSI150 & DIN16
- Lugged table D, E & ANSI150 available on request

### Working Pressure

- 232 PSI (16 bar)

### Available Control Options

- Namur solenoid valves
- Limit switch box
- Proximity switch box
- Electro-pneumatic
- Smart digital positioners
- Air filter/regulators
- Speed controllers and silencers

Size		Part Numbers	
mm	inch	Double Acting	Spring Return
50	2	VBF-IBFW050-DA	VBF-IBFW050-SR
65	2½	VBF-IBFW065-DA	VBF-IBFW065-SR
80	3	VBF-IBFW080-DA	VBF-IBFW080-SR
100	4	VBF-IBFW100-DA	VBF-IBFW100-SR
125	5	VBF-IBFW125-DA	VBF-IBFW125-SR
150	6	VBF-IBFW150-DA	VBF-IBFW150-SR
200	8	VBF-IBFW200-DA	VBF-IBFW200-SR



## Spray Guns

### Anti-Fatigue Spray Gun



#### Features

- 3/8" female inlet
- 1/4" female outlet
- Anti-fatigue pressure compensating design

#### Specification

- Maximum temperature to: 160°C (320°F)

Part Number	Maximum PSI	GPM
HPSG	5075	12.0

### Heavy Duty Anti-Fatigue Spray Gun



#### Features

- 3/8" female inlet
- 1/4" female outlet
- Heavy duty anti-fatigue design
- Stainless inner tube
- Zytel® housing

#### Specification

- Working pressure: 5800 PSI
- Maximum temperature: 160°C (320°F)

Part Number	GPM
HPSGHD	8.0

### Pressure Spray Gun



#### Features

- 3/8" female inlet
- 1/4" female outlet

#### Specification

- Working pressure: 4500 PSI
- Maximum temperature: 160°C (320°F)

Part Number	GPM
HPSGL	8.0

## Moulded Grip Extensions

### Features

- For use with HPSG, HPSGC, HPSGHD and HPSGW

### Specification

- Maximum operating pressure 5000 PSI
- Temperature 150°C (302°F)
- 10.5 GPM maximum



Length (inch)	Part Numbers	Description
24	AL323XX	1/4" male inlet x 1/4" male outlet
36	AL324XX	1/4" male inlet x 1/4" male outlet, 4" space from the end
48	AL325XX	1/4" male inlet x 1/4" male outlet, 2 grips
59	AL326XX	1/4" male inlet x 1/4" male outlet, 2 grips

## Turbo Nozzles

### Features

- 20° spray angle
- Ceramic orifice

### Specification

- Maximum temperature 100°C (212°F)

Nozzle Size	Part Numbers	Orifice (mm)	Description	Maximum Working Pressure (PSI)
4.0	AL-TPR25-30	1.30	1/4" female inlet	3700
6.0	AL-TPR25-50	1.50	1/4" female inlet	3700
7.0	AL-TPR25-70	1.70	1/4" female inlet	3700
4.0	AL-TPR35-30	1.30	1/4" female inlet	5075
6.0	AL-TPR35-50	1.50	1/4" female inlet	5075
7.0	AL-TPR35-70	1.70	1/4" female inlet	5075



# Strategically located sales & distribution centres to support you.

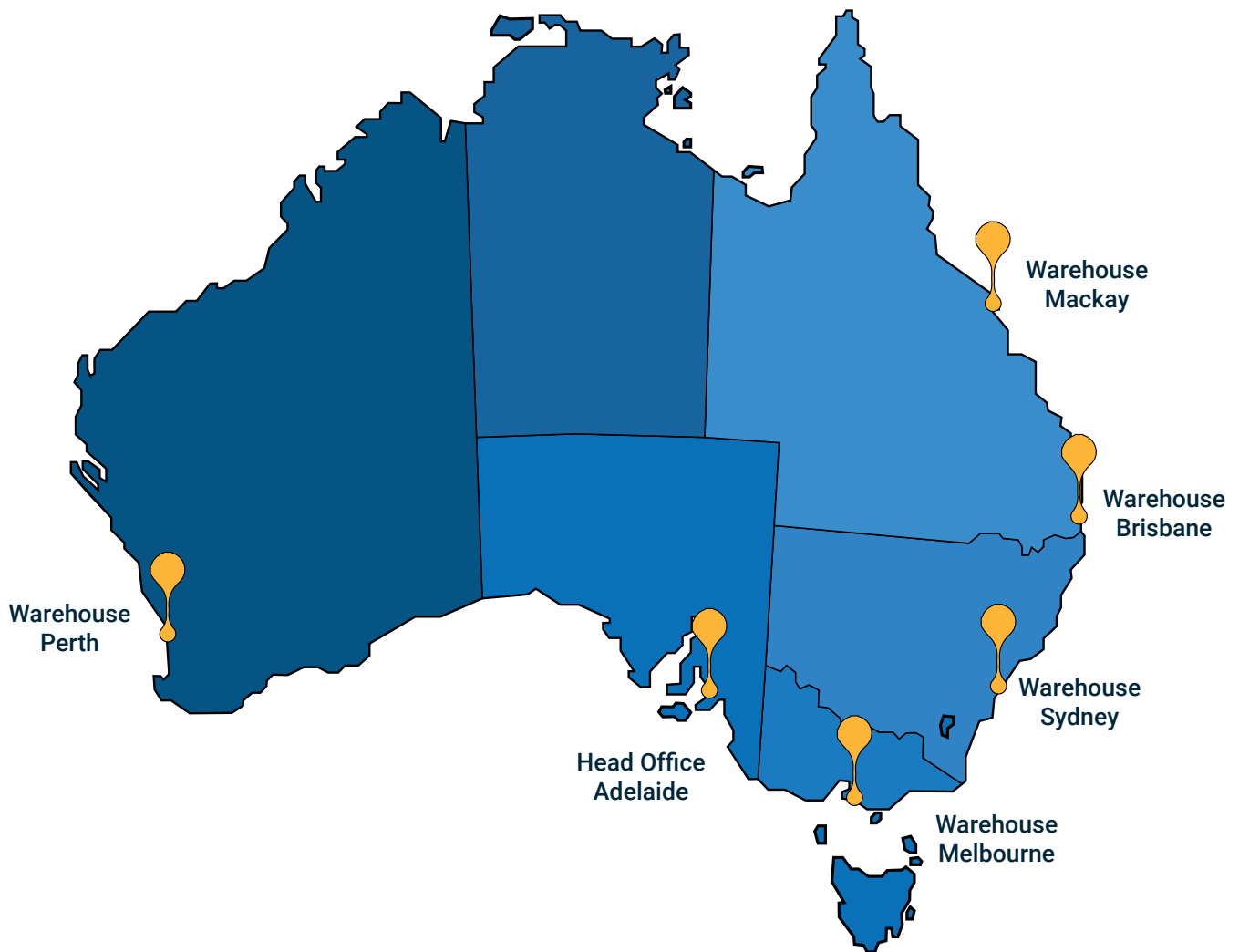

## CONTACT LIST

# Sales Team

---

### **Adam Burdon**

**Business Development Manager  
South Australia / Northern Territory**

aburdon@dixonvalve.com.au  
0456 602 838

### **Paul Wood**

**Territory Manager  
Queensland**

pwood@dixonvalve.com.au  
0451 669 687

### **Michael Bennecke**

**Territory Manager  
Western Australia**

mbennecke@dixonvalve.com.au  
0417 823 660

### **Paul Christie**

**Territory Manager  
Victoria / Tasmania**

pchristie@dixonvalve.com.au  
0414 779 653

### **Ray Collyer**

**Territory Manager  
New South Wales**

rcollyer@dixonvalve.com.au  
0404 204 579

### **Peter Crossley**

**Territory Manager  
New Zealand**

pcrossley@dixonvalve.com.au  
0422 729 739



*The Right Connection®*

**Dixon (Asia Pacific) Pty Ltd**

170 Francis Road  
Wingfield SA 5013

1300 134 651

**[dixonvalve.com.au](http://dixonvalve.com.au)**

**Adelaide, South Australia**

(Head Office)  
170 Francis Road  
Wingfield SA 5013

**Brisbane, Queensland**

6 Union Circuit  
Yatala QLD 4207

**Mackay, Queensland**

38 John Vella Drive  
Paget QLD 4740

**Melbourne, Victoria,**

13 Commercial Drive  
Dandenong VIC 3175

**Perth, Western Australia,**

19 Baile Road  
Canning Vale WA 6155

**Sydney, New South Wales**

15 Watsford Road  
Campbelltown NSW 2560