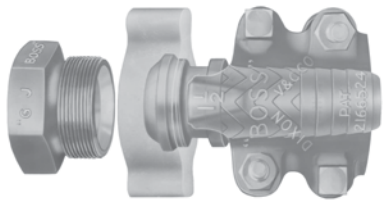

Boss Ground Joint Seal

GROUND JOINT
Positive Metal-to-Polymer Seal

- A leakproof seal is formed when the metal head of the stem makes contact with the patented polymer seat in the spud.
- The non-metallic polymer seat resists most chemicals found in manufacturing facilities.
- Recommended for steam service up to 230° C.
- Easy to seal.
- Plated steel and/or malleable iron.
- Use with Dixon Boss Clamps in this catalogue.

Coupling with Female Spud

Size (inch)	Size (mm)	NPT		BSP	
		Part No.	Price \$	Part No.	Price \$
¼	6*	GF1	60.65	GF1A	52.79
⅜	9.5*	GF3	51.70	GF3A	57.03
½	15	GF6	40.57	GF6A	45.13
¾	20	GF26	49.32	GF26A	53.25
1	25	GF36	50.92	GF36A	55.01
1¼	32	GF51	92.84	GF51A	101.53
1½	40	GF61	86.11	GF61A	94.08
2	50	GF81**	102.88	GF81A	111.06
2½	65	GF96	264.96	GF96A	287.26
3	75	GF111	274.17	GF111A	298.34
4	100	GF141	612.25	GF141A	654.79

Price Group: SD

Stem

Size (inch)	Size NB (mm)	Part No.	Price \$
¼	6*	GBA i	23.29
⅜	9.5*	GCA i	10.82
½	15	GB1	9.21
¾	20	GB6	18.01
1	25	GB11	18.89
1¼	32	GB16	28.20
1½	40	GB21	25.20
2	50	GB26**	28.10
2½	65	GB31	67.90
3	75	GB36	81.35
4	100	GB46	190.80
6	150*	GB66 i	453.33

Price Group: SD

AD01



SAFETY ALERT

- *6mm, 9.5mm & 150mm come only with Copper seat spuds.
- **Not to be used with #250, #275 or #306 Boss Clamps.

- Boss Couplings and the Steam Quick Disconnects are the only Dixon Couplings recommended for steam service.