

5020 - BSP Reducing Bush

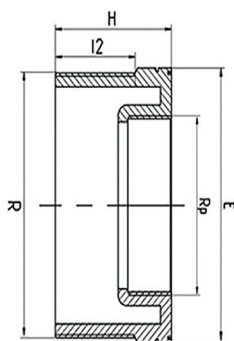

R (mm)	Rp (mm)	Part No.	H (mm)	l2 (mm)	E (mm)	Weight (g)	Price \$
3/4"	1/2"	PTF-BUSH-20-15	30	17	27	6	4.12
1"	1/2"	PTF-BUSH-25-15	32	19	36	16	4.12
1"	3/4"	PTF-BUSH-25-20	32	19	36	11	4.12
1 1/4"	3/4"	PTF-BUSH-32-20	37	21	46	28	5.04
1 1/4"	1"	PTF-BUSH-32-25	37	21	46	21	5.04
1 1/2"	3/4"	PTF-BUSH-40-20	37	21	50	30	5.78
1 1/2"	1"	PTF-BUSH-40-25	37	21	50	32	5.78
1 1/2"	1 1/4"	PTF-BUSH-40-32	37	21	50	20	5.78
2"	3/4"	PTF-BUSH-50-20	41	25	63	58	6.43
2"	1"	PTF-BUSH-50-25	41	26	63	61	6.43
2"	1 1/4"	PTF-BUSH-50-32	41	26	63	55	6.43
2"	1 1/2"	PTF-BUSH-50-40	41	26	63	44	6.43
2 1/2"	2"	PTF-BUSH-65-50	44	29	80	75	19.24
3"	2"	PTF-BUSH-80-50	48	32	90	103	24.56
4"	3"	PTF-BUSH-100-80	56	41	120	222	24.56

Price Group: SD

MS01

5060 - BSP Nipple

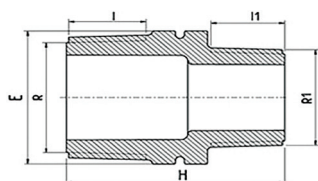

R (mm)	Part No.	H (mm)	l (mm)	E (mm)	Weight (g)	Price \$
1/2"	PTF-HN-15	47	17	22	8	1.99
3/4"	PTF-HN-20	49	18	27	11	2.59
1"	PTF-HN-25	55	20	36	23	3.10
1 1/4"	PTF-HN-32	60	22	46	35	4.12
1 1/2"	PTF-HN-40	61	22	50	48	5.04
2"	PTF-HN-50	71	26	65	78	7.03

Price Group: SD

MS01

5060 - BSP Reducing Nipple

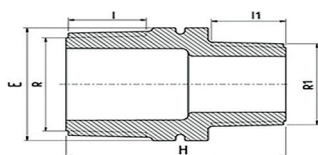

R (mm)	R1 (mm)	Part No.	H (mm)	l (mm)	l1 (mm)	E (mm)	Weight (g)	Price \$
3/4"	1/2"	PTF-HN-20-15	47	17	16	27	10	3.01
1"	1/2"	PTF-HN-25-15	49	19	16	36	17	3.75
1"	3/4"	PTF-HN-25-20	50	19	17	36	18	3.75
2"	1"	PTF-HN-50-25	61	25	19	63	53	6.94

Price Group: SD

MS01