

F-Series Manual Industrial Interchange Coupler

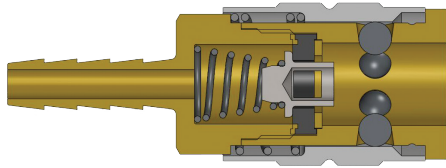

Standard Hose Barb

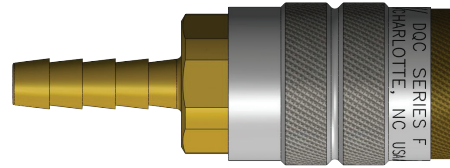

Body Size (inch)	Part No.	Hose ID (inch)	Body Material	Weight (kg)	Pkg Qty		Price \$ (ea)
					Bag	Box	
1/4	2FS2	1/4	Steel	0.08	10	100	27.71
1/4	2FS2-B	1/4	Brass	0.08	10	100	16.37
1/4	2FS2-S	1/4	303 SS	0.08	10	100	55.01
1/4	2FS2.5-B	5/16	Brass	0.08	10	100	19.47
1/4	2FS3-B	3/8	Brass	0.08	10	100	15.94
1/4	2FS3-S	3/8	303 SS	0.09	10	100	95.86
3/8	3FS2	1/4	Steel	0.12	10	50	36.54
3/8	3FS3	3/8	Steel	0.12	10	50	27.17
3/8	3FS3-S	3/8	303 SS	0.13	10	50	122.14
3/8	3FS4	1/2	Steel	0.13	10	50	26.73
1/2	4FS3	3/8	Steel	0.19	5	30	33.11
1/2	4FS4	1/2	Steel	0.20	5	30	32.11
1/2	4FS4-S	1/2	303 SS	0.20	5	30	135.58
1/2	4FS6	3/4	Steel	0.22	5	30	33.26

Price Group: PC

AN01

DF-Series Industrial Interchange Nipple

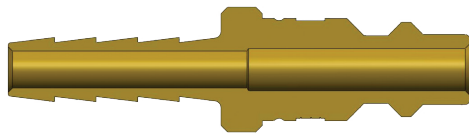

Standard Hose Barb

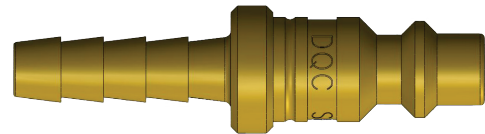

Body Size (inch)	Part No.	Hose ID (inch)	Body Material	Weight (kg)	Pkg Qty		Price \$ (ea)
					Bag	Box	
1/4	D2S2	1/4	Steel	0.02	10	100	4.30
1/4	D2S2-S	1/4	303 SS	0.02	10	100	16.49
1/4	D2S2.5	5/16	Steel	0.02	10	100	8.70
1/4	D2S3	3/8	Steel	0.02	10	100	4.33
1/4	D2S3-B	3/8	Brass	0.02	10	100	4.44
1/4	D2S3-S	3/8	303 SS	0.02	10	100	16.53
3/8	D3S2	1/4	Steel	0.03	10	50	15.41
3/8	D3S3	3/8	Steel	0.03	10	50	5.69
3/8	D3S3-B	3/8	Brass	0.04	10	50	16.02
3/8	D3S3-S	3/8	303 SS	0.04	10	50	17.67
3/8	D3S4	1/2	Steel	0.04	10	50	5.79
1/2	D4S3	3/8	Steel	0.04	10	50	10.53
1/2	D4S3-B	3/8	Brass	0.05	10	50	12.98
1/2	D4S4-B	1/2	Brass	0.05	10	50	12.93
1/2	D4S4-S	1/2	303 SS	0.05	10	50	23.39
1/2	D4S6	3/4	Steel	0.08	10	50	15.49
1/2	D4S6-B	3/4	Brass	0.08	10	50	16.73
3/4	D6S4	1/2	Steel	0.09	5	20	36.51
3/4	D6S6	3/4	Steel	0.10	5	20	42.74
3/4	D6S8	1	Steel	0.16	5	20	75.21

Price Group: PC

AN01



It is important to be safe when installing quick disconnect couplings into a pneumatic circuit. Never install a pneumatic coupling directly into an air tool, use a piece of hose that is at least 18" long, between the tool and the coupling, to prevent damage to the coupling. To protect the operator, safety devices, such as a safety check valve and safety cable should be installed in case there is a hose or coupling failure.

FOR TECHNICAL GUIDELINES PLEASE REFER TO PAGE 260



1300 134 651
dixonvalve.com.au

All prices exclude GST.
ADPL718