

Minsup™ Safety Claw Clamps



C



Material:	SG Iron ISO 1083
Protection:	Zinc Plated
Inserts:	Inserts in 1/2", 3/4" and 1" clamps are made from nylon

Nom. ID	Hose OD (mm)		Bolt Torque		Part No.	Pkg Qty	Price \$ (ea)
	From:	To:	ft-lbs	Nm			
1/2"	22	28	18.4	25	08/023/42/000	100	13.91
3/4"	29	34	18.4	25	08/023/43/000	50	15.20
1"	35	40	25.8	35	08/023/46/000	50	11.62

Price Group: MS
AC03



Selecting the correct clamping device is critical to the performance and safety of any hose assembly. The clamp provides a combination of friction and lock in retaining the coupling to the hose.

If you are unsure of the correct clamp for the application, coupling or hose type, contact Dixon™ on 1300 134 651.

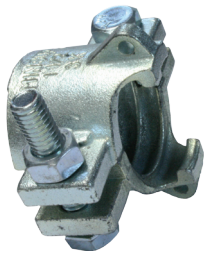

Without Chain

Nom. ID	Hose OD (mm)		Bolt Torque		Part No.	Pkg Qty	Price \$ (ea)
	From:	To:	ft-lbs	Nm			
1 1/2"	51	58	50	67.8	08/023/05/000	20	34.56
2"	65.5	71	60	81.3	08/023/03/000	15	43.29

Price Group: MS
AC03



With Chain

Nom. ID	Hose OD (mm)		Bolt Torque		Part No.	Pkg Qty	Price \$ (ea)
	From:	To:	ft-lbs	Nm			
1 1/2"	51	58	50	67.8	08/023/06/000	20	58.17
2"	65.5	71	60	81.3	08/023/04/000	15	65.07

Price Group: MS
AC03



WARNING: Worn-out hose fittings should be replaced. Loose clamps on hose can be dangerous. Bolt type clamps should be retensioned regularly. For extra safety, retaining devices such as clips, chains or cables must be used. Dixon™ strongly recommends the use of a safety tag or warning label on all hose assemblies. Refer to Technical section for more information.

Chain Restrainers



Suits Clamp Size	Chain Size	Part No.	Price \$ (ea)
1 1/2" and 2"	1/8"	08/023/01/047A	18.16

For use with Minsup™ double bolt claw clamp.
Replacement chain to suit 1 1/2" & 2" clamp size

Price Group: MS
AC03



Not recommended as a replacement for a whipcheck. Refer to pages 127 and 136 for additional information. Please contact Dixon™ for further information.

Minsup™ Double Bolt Clamps



Nom. ID	Hose OD (mm)		Torque Nm		Part No.	Pkg Qty	Price \$ (ea)
	From:	To:	ft-lbs	Nm			
1/2"	24	27	18.4	25	08/023/14/000	100	10.48
3/4"	31	33	18.4	25	08/023/15/000	50	13.08
1"	37	39	25.8	35	08/023/13/000	50	12.10

Price Group: MS
AC03

